

Small-Signal Schottky Diodes

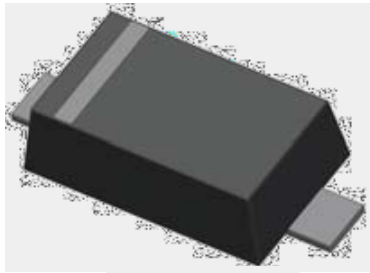

SOD523

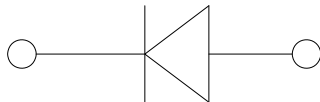

Features

- " (SR[\ PPHWV 8/ 9 ELICOLDV\ PUDWLQJ DQG KDO
- " 0RLVWXUH 6HQVLWLYLW\ /HYHO
- " $I_{S0} = 9$
- " $I_{S9} = P\$$
- " 3DUW QR ZLWKH\XIVL\$(34 4 TXDOLILHG

Mechanical Data

- " **Package** 62'
- " **Terminals** 7LQ SODWHG OHDGV VROGHUDEOH S
- 67' DQG -(6' %
- " **Polarity:** &DWKRGH OLOWKBFORWKIRGH HQG
- " **Marking:** 4B

Maximum Ratings

PARAMETER	SYMBOL	UNIT	Conditions	VALUE
5HSHWLWLYH SHDN UHYHUVH YR	I_{RMS}	A	9	
3HDN)RUZDUG 6XUJH &XUUHQW	I_{SM}	A	, 0.05 p 0.05 p 0.05 p 0.05 p 0.05 p	
\$YHUDJH IRUZDUG FXUUHQW	I_{SM}	P\$,	
7KHUPDO 5HVLVWDQFH -XQFWLRQ	$R_{\theta JC}$	$^{\circ}C/W$		
3RZHU GLVVLSDWLRQ		P	3	
0D[LPXP MXQFWLRQ WHPSHUDWXUH	T_{JM}	$^{\circ}C$		WR
6WRUDJH WHPSHUDWXUH UDQJH	T_{VJ}	$^{\circ}C$		WR



vCharacteristics 7 \ S L F D O

Fig.1: PD- T_A

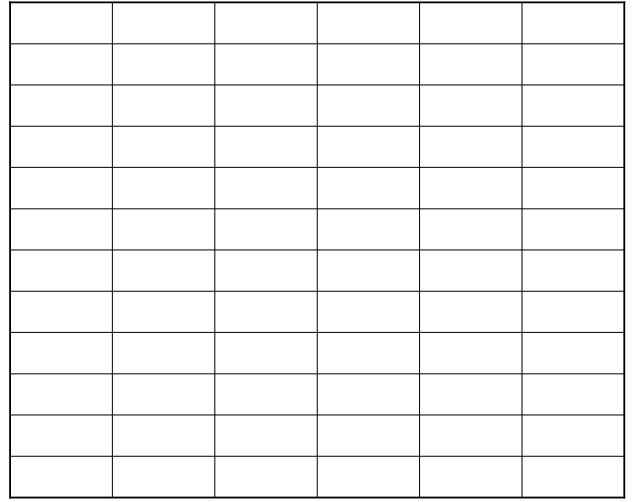
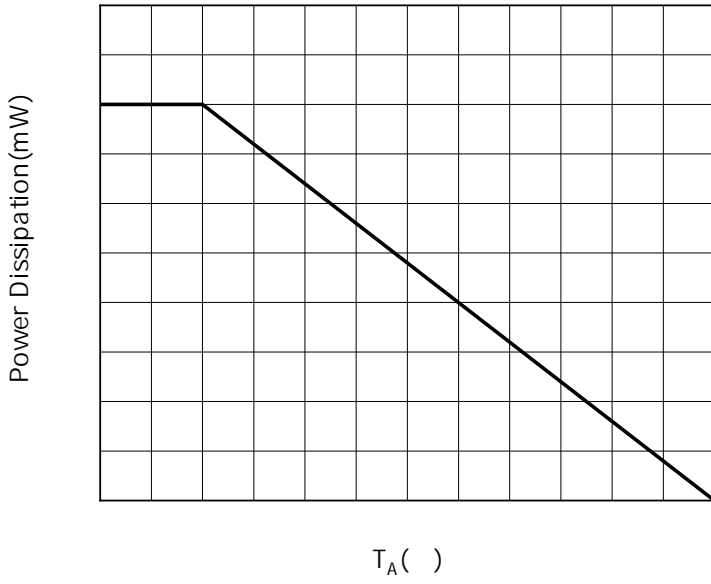



RB751S-40Q

vOutline Dimensions

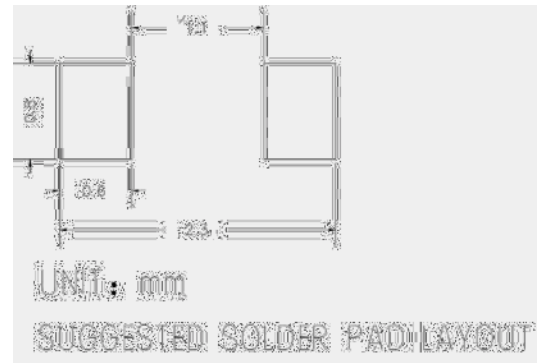
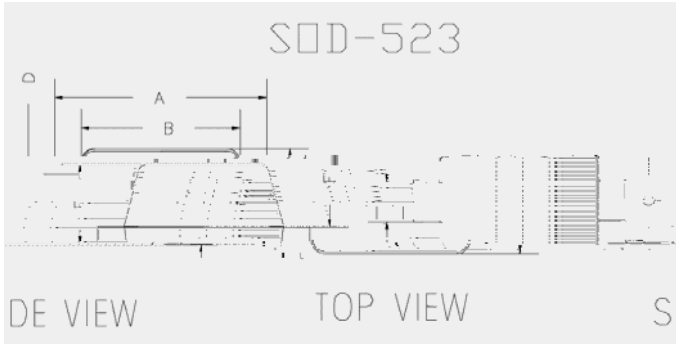

DIMENSIONS				
DIM	INCHES		MM	
	MIN	MAX	MIN	MAX
A	0.059	0.067	1.500	1.700
B	0.043	0.051	1.100	1.300
C	0.028	0.035	0.700	0.900
D	0.010	0.014	0.250	0.350
E	0.002	0.008	0.050	0.200

vMarking Information

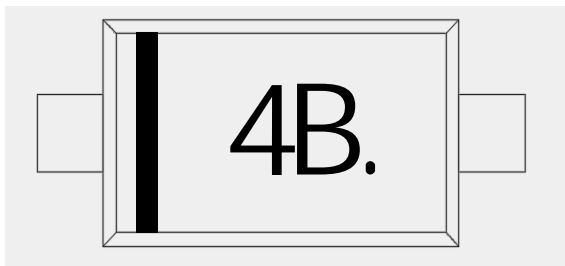

```

1RWH
$OO PDUNLQJ LV DW PLGGOH RI WKH SURGXFW ERG\
$OO PDUNLQJ LV LQ ODVHU PDUNLQJ
%RG\ FRORU %ODFN
  
```



RB751S-40Q

Disclaimer

7KH LQIRUPDWLRQ SGRVHQMHG LQ IRWLVHDIHQJHQRK BQJMLH (OHFWURQLF 7HFKQRO
ULJKW WR PDNH FKDLFHVRZLWKR XWSKRLSULFDGXIFRQV FGLWSOD\HG KHUHLQ WURGLFVSLWRQ
RU RWKHUZLVH

The product listed herein is designed to be used with automotive electronics. It is not designed for use in medical, life saving, lifesustaining, or military. Yangjie or anyone on its behalf, assumes no responsibility or liability for any damages resulting from such improper use of sale.

7KLV SXEOLFDWLRQ IS ODFHUVHDIHQJHQRK BQJMLH (OHFWURQLF 7HFKQRO
ULJKW WR PDNH FKDLFHVRZLWKR XWSKRLSULFDGXIFRQV FGLWSOD\HG KHUHLQ WURGLFVSLWRQ
RU RWKHUZLVH