

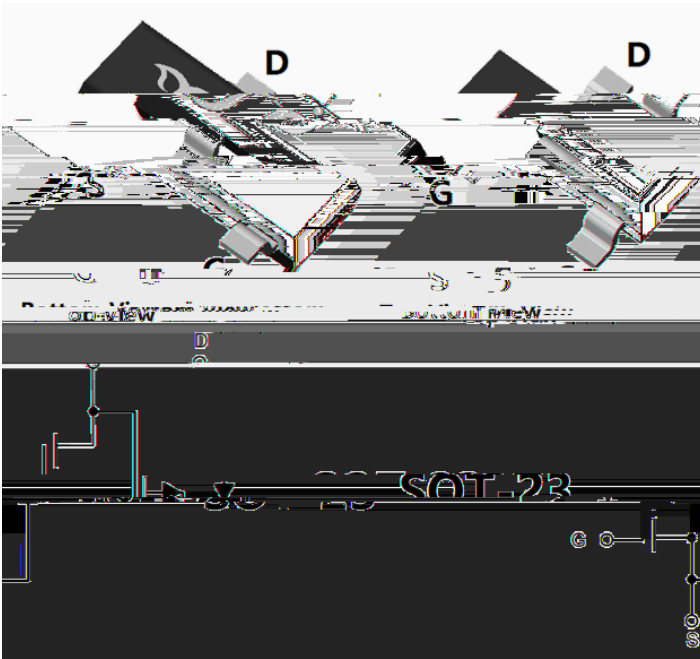

P-Channel Enhancement Mode Field Effect Transistor



Product Summary

" 96
 " 56 21 DW 9 9 Ø PRKP
 " 56 21 DW 9 9 Ø PRKP
 " 56 21 DW 9 9 Ø PRKP

General Description

" 7UHQFK 3RZHU /9 026)(7 WHFKQRORJ\
 " +LJK 3RZHU DQG &XUUHQW KDQGLQJ F
 " /RZ *DWH &KDUJH
 " 3DUW QR ZLWRKHDXIVL\$(84 4 TXDOLILH

Applications

" %DWWHU\ SURWHFWLWLRQ
 " 3RZHU PDQDJHPHQW
 " /RDG VZLWFK

vAbsolute Maximum Ratings 7s À |nÆÇvG...ÛE (•€E4 0" ò"4 b 9!v9 ûy€ ~2S,,c, • 0\$

	7s -			
3XOVHG 'UDLQ &XUUHQW				
7RWDO 3RZHU 'LVVLSDWLRQ	7s - 7s -			:
7KHUPDO 5HVLVWDQFH -XQFWLRQ WR \$PELHQW				- :
-XQFWLRQ DQG 6WRUDJH 7HPSHUDWXUH 5DQJH			7	-

vOrdering Information ([DP SOH

PREFERRED P/N	PACKING CODE	Marking	MINIMUM PACKAGE(pcs)	INNER BOX QUANTITY(pcs)	OUTER CARTON QUANTITY(pcs)	DELIVERY MODE
< - / % 4)	%6				3 UHHO



YJL2305BQ

vElectrical Characteristics 7 XQOHVV RWKHUZZLVH QRWHG

Parameter	Symbol	Conditions	Min	Typ	Max
Static Parameter					
'UDLQ 6RXUFH %UHDNGRZC 9ROWDJH		·6 9%9 \$	9		9
HUP *DWH 9ROWDJH 'UDLQ & XUHHQW		9 ₆ 9 9 9 7M			
		9 ₆ 9 9 9 7M			
*DWH %RG\ /HDNDJH & XUHHQW		·66 " 9 9 9	9		"
*DWH 7KUHVKROG 9ROWDJH		·6 WK 9 ₆ , \$	9		9

6WDWLF 'UDLQ 6RXUFH 2Q 5HVLVWDQFH 5



YJL2305BQ

Typical Performance Characteristics

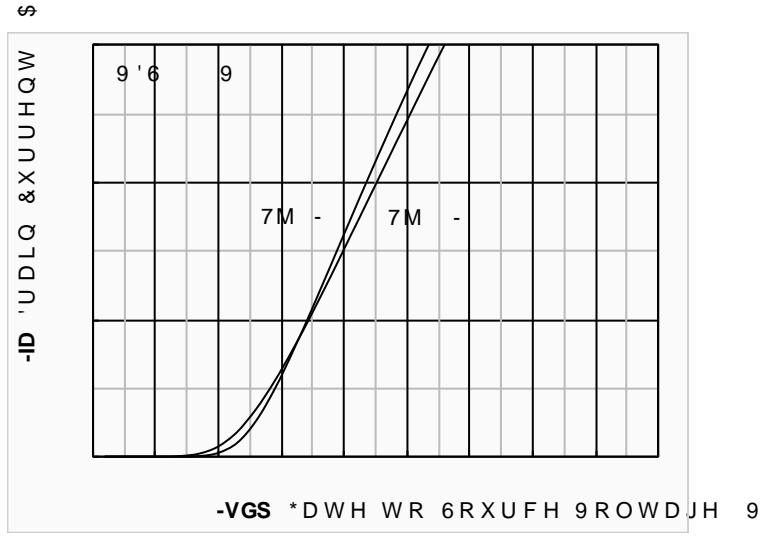

)LJXUH 2XW8KWW&KDUDFW

)LJXUH 7UDQVIHU &K



)LJXUH &DSDFLWDQFH &KDUDFWHULVWLFV)LJXUH *DWH &KD

)LJXUH 2Q 5HVLVWDQFH 6RXUJH 9ROWDJH)LJXUH 5HVLVWDQFH



YJL2305BQ

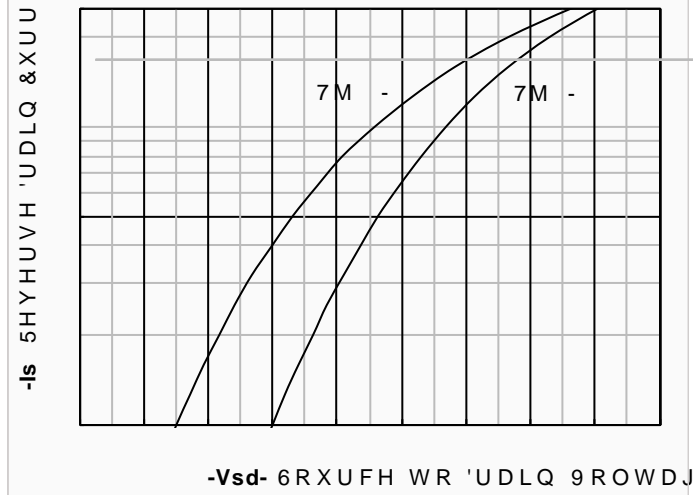
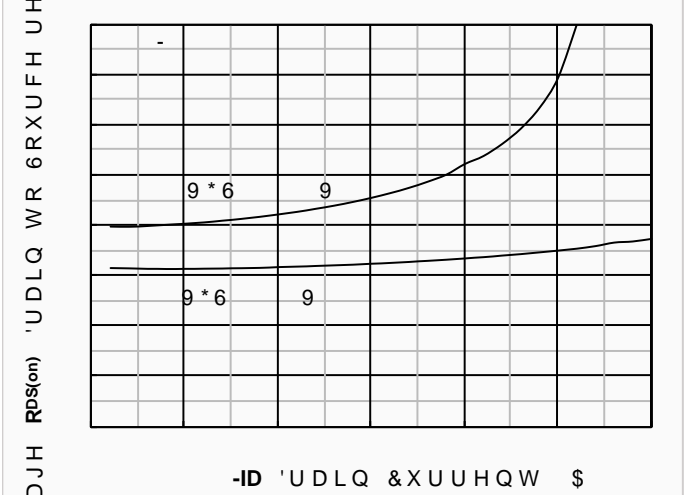

)LJXUH 6 RQ96 'UDLQ & XUHHQW \$

)RUZDUG FKDUJDFWHULVWLFV

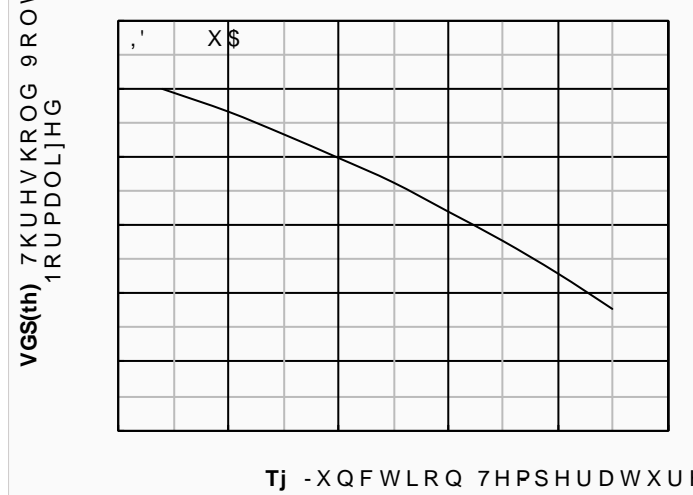
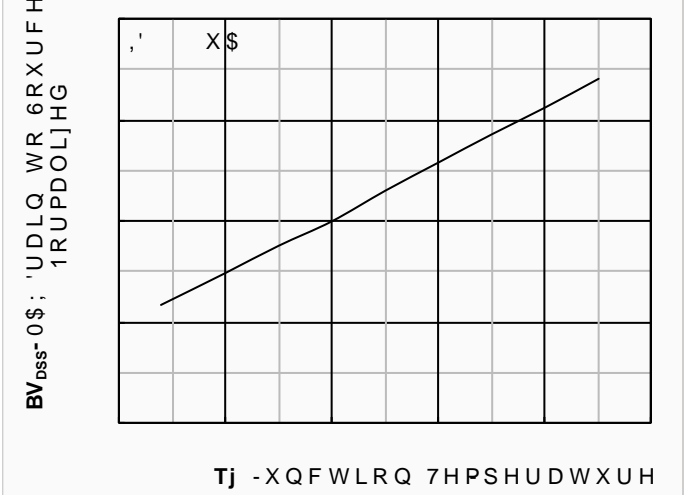

Tj -XQFWLRQ 7HPSHUDWXUH

Tj -XQFWLRQ 7HPSHUDWXUH

)LJXUH 1RUPDOLJHG 7KUHVKROG 9ROWDJH

)LJXUH 1RUPDOLJHG 7KUHVKROG 9ROWDJH



6TXDUH :DYH 3XOVH 'XUWLRQ

)LJXUH 0D[LPXP7KUHVKROG 9ROWDJH

)LJXUH 6DIH 2SHUDWL



YJL2305BQ

vSOT-23 Package Outline Dimensions

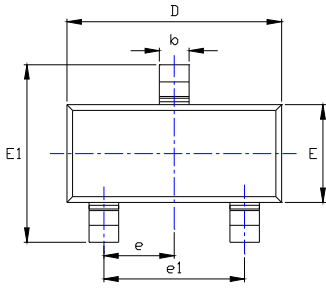

: 56 </+ =

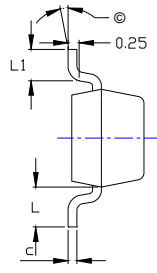

9 / * + < / + =

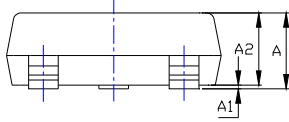

9 / * + < / + =

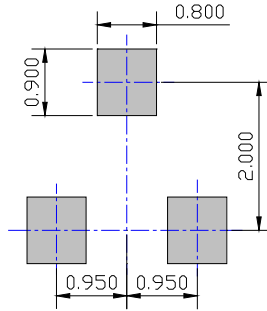

81, Ø PP

9; --+9: + * 952 * + 8 6 ' * 2 ' ? 5 ; :

SYMBOL	DIMENSIONS			
	INCHES		Millimeter	
	MIN.	MAX.	MIN.	MAX.
A	0.035	0.045	0.900	1.150
A1	0.000	0.004	0.000	0.100
A2	0.035	0.041	0.900	1.050
b	0.012	0.020	0.300	0.500
c	0.004	0.008	0.100	0.200
D	0.110	0.118	2.800	3.000
E	0.047	0.0		

