





**Thermal Characteristics**



# ASM05

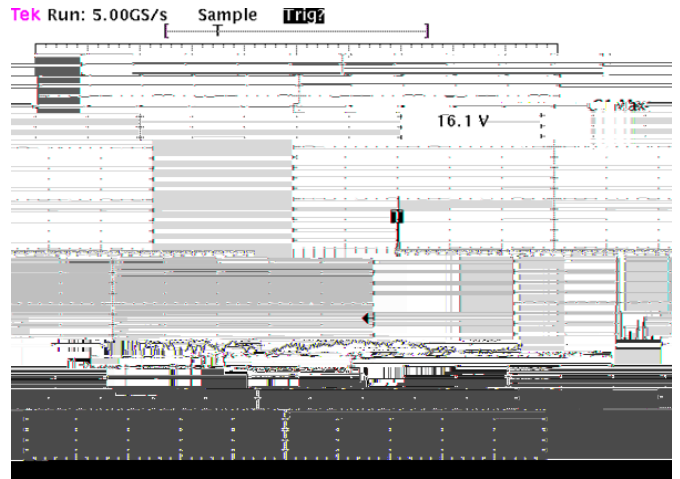
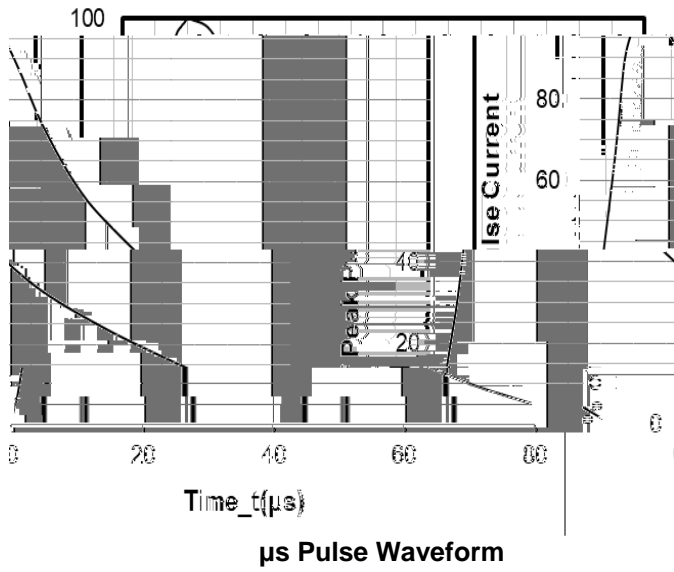

Note Data is taken with a 10x attenuator  
ESD Clamping Voltage  
8 kV Contact per IEC61000-4-2

## Outline Dimensions

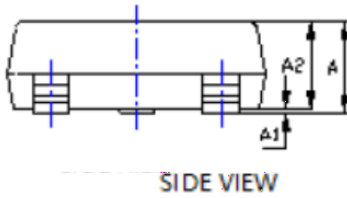
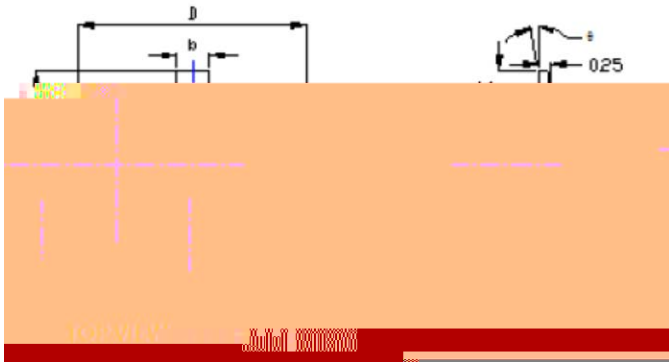

DIMENSIONS					
	MAX	MIN	TYP	MAX	MIN
00.00	0.0845	0.0635	0.0762	0.0000	0.00
50I	A2	0.035	0.043	0.900	1.04
60.00	0.200		0.084	0.008	0.100
70.00	0.100		0.055	0.020	0.030
80.00	0.080		0.010	0.050	0.050
90.00	0.200		0.076	0.028	0.038
100.00	0.020		0.030	0.500	0.71

## Soldering Footprint

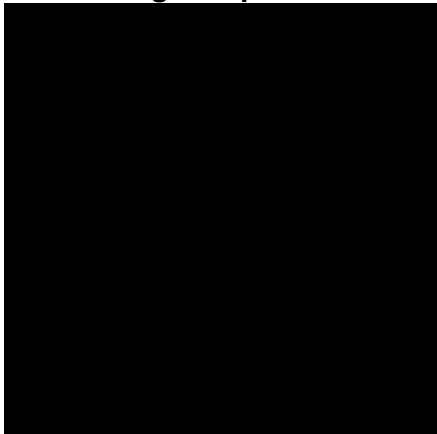



---